

Santa on Skis

Created by Shoko Aoyagi
Diagrams by Shoko Aoyagi

© Shoko Aoyagi November 2006

You need a sheet of red origami paper.

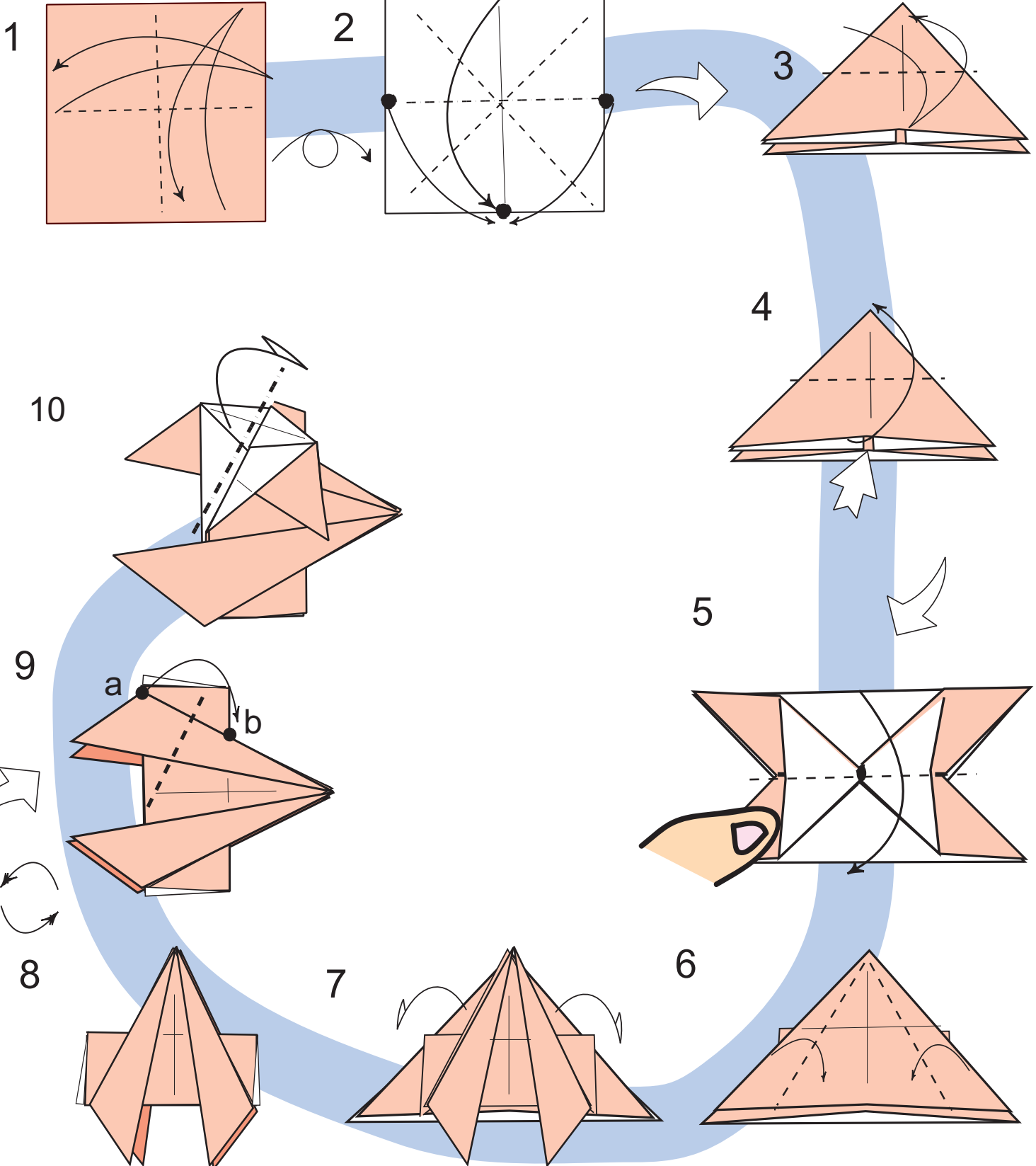

Santa on Skis

Created by Shoko Aoyagi
Diagrams by Shoko Aoyagi

2/2

© Shoko Aoyagi November 2006

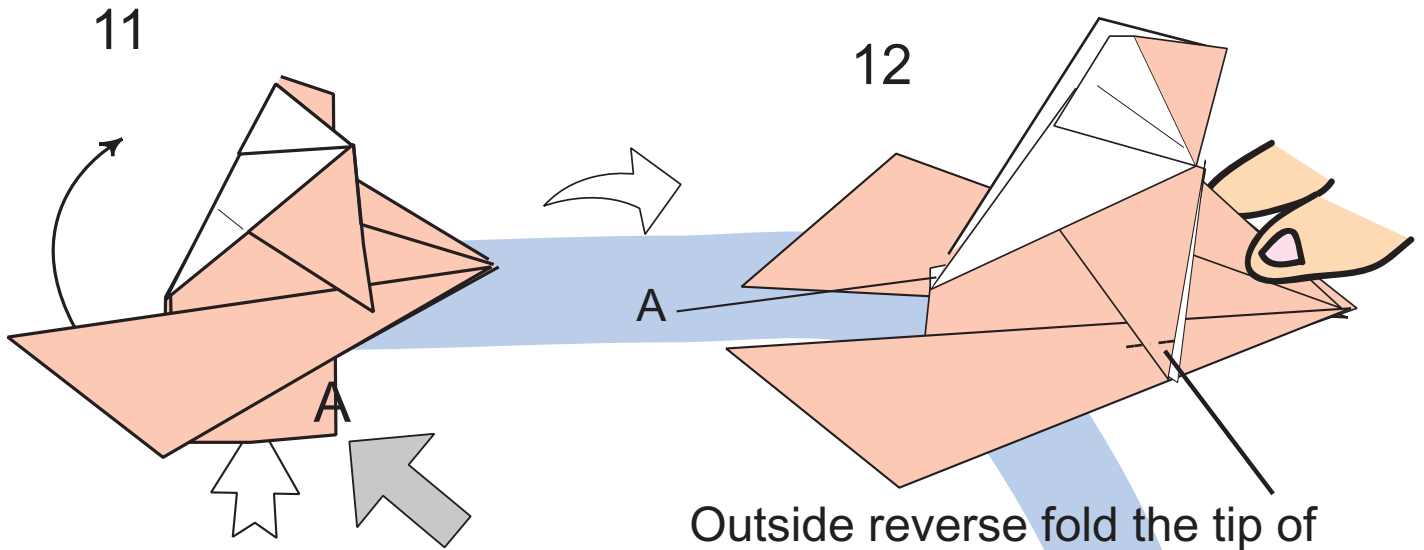

Press A to flatten the bottom.

Glue together the two layers of paper.

13

Beard

Draw a face and add a sticker nose.

Glue on a greeting card as shown.

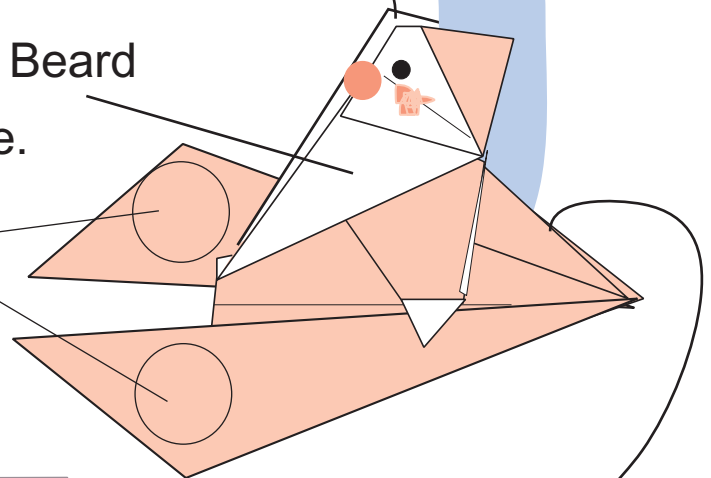

Here is a pocket for small gifts.

